

S-1140/S-1240 Resilient seat gate valve DN 200-300

DIN F4 short/DIN F5 long

02-03/1039002291/01.2007 **2**
Page 1 of 2

Application and features

- Application: Water and sewage
- Wedge in EPDM-rubber approved for drinking water
- Design pressure 64 bar
- Water lubricated sleeve bearings to reduce operating torque
- 1/4" manual bonnet air relief valve
- Clockwise closing

Technical description

- Approvals: See separate sheet [\[Approvals\]](#)
- Design standards: DIN 3352-1/4, DIN 3840, EN 545, EN 12266, ISO 7259, EN 1074, EN 1171
- Face-to-face length S-1140: EN558/ ISO 5752 series 14
- Face-to-face length S-1240: EN558/ ISO 5752 series 15
- Max. working pressure: PN 16, vacuum -0,8 bar
- Flange drilling: Standard drilling PN 10 (EN1092-2), PN 16 on request
- Max. temperature: 60°
- Test pressure open valve: 24 bar
- Test pressure closed valve: 21 bar
- Coating: Epoxy minimum 250 µm
- Product colour: Bue, RAL 5017
- Body/bonnet connection: Socket head bolts covered with wax
- Valve top: Prepared for spindle extension S-1881
- Stem: Non-rising with tapered stem end, according to DIN 87304 (see table)

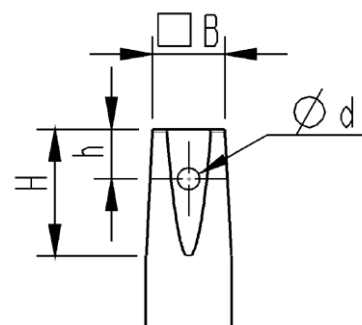

Dimensions stem top:

DN	B	H	h	d
200-300	27,3	47	18,5	8

References, dimensions and performances

Series	DN mm	Flange-drilling	H mm	L mm	Weight kg	Kv m ³ /h	Z	Esco no.	NRF no.	Danfoss no.
S-1140	200	PN 10	536	230	59	4090	0,15	11400205	550 6054	149L816000
	200	PN 16	536	230	59	4090	0,15	11400206		149L816100
	250	PN 10	639	250	86	6390	0,15	11400250	550 6059	149L076300
	250	PN 16	639	250	86	6390	0,15	11400251		149L076400
	300	PN 10	728	270	128	9202	0,15	11400300	550 6064	149L076500
	300	PN 16	728	270	128	9202	0,15	11400301		149L076600
S-1240	200	PN 10	536	400	76	4090	0,15	12400205	550 5416	149L816400
	200	PN 16	536	400	76	4090	0,15	12400206		149L816500
	250	PN 10	639	450	101	6390	0,15	12400250	550 5417	149L079400
	250	PN 16	639	450	101	6390	0,15	12400251		149L079500
	300	PN 10	728	500	136	9202	0,15	12400300	550 5418	149L079600
	300	PN 16	728	500	136	9202	0,15	12400301		149L079700

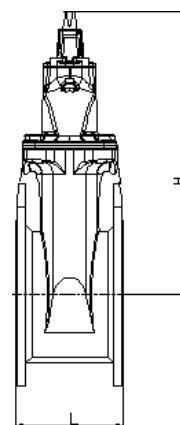

Kongsberg Esco AS can accept no responsibility for possible errors in catalogues, brochures and other printed material. Kongsberg Esco AS reserves the right to alter its products without notice. This also applies to products already on order provided that such alterations can be made without subsequent changes being necessary in specifications already agreed. All trademarks in this material are property of the respective companies. Kongsberg Esco and the Kongsberg Esco logotype are trademarks of Kongsberg Esco AS. All rights reserved.

S-1140/S-1240 Resilient seat gate valve DN 200-300

DIN F4 short/DIN F5 long

02-03/1039002291/01.2007 **2**

Page 2 of 2

Material specification

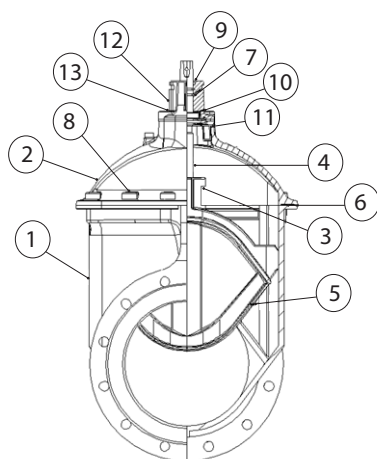

Pos	Detail	Materials
1	Body	Ductile iron EN 1563 EN-GJS-500-7
2	Bonnet	Ductile iron EN 1563 EN-GJS-500-7
3	Stem nut	Dezinkfree brass (DZR)/bronze
4	Stem	Stainless steel EN10088-3 1.4021
5	Wedge	Ductile iron EN1563 EN-GJS-500-7 with rubber (EPDM)
6	Gasket	Rubber approved for drinking water
7	O-rings	Rubber approved for drinking water
8	Socket head bolt	Steel 8.8
9	Dirt seal	Rubber (NBR)
10	Sleeve bearing	Composite
11	Sealing ring	POM
12	Stuffing box	Dezinkfree brass (DZR)
13	¼" air relief valve	Dezinkfree brass (DZR)

Installation

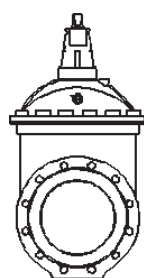

Recommended

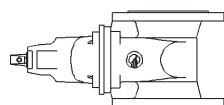

Possible

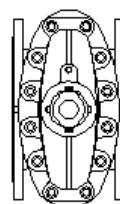

Possible

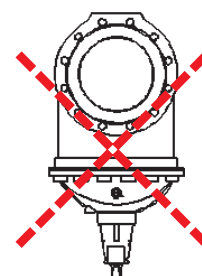

Not recommended

Accessories and other variants

Accessories:

- S-1120/S-1121 Norwegian cap
- S-1110 Handwheel
- S-1112 Handwheel extension L=355 (DN 200)
- S-1112 Handwheel extension L=195 (DN 250-300)
- S-1881 Spindle extension
- S-1880-0 Operating tool bar
- S-1830/S-1835/S-1840 Operating box

Other variants:

- S-1140/S-1240 Clockwise closing DN 40-50
- S-1140/S-1240 Clockwise closing DN 65
- S-1140/S-1240 Clockwise closing DN 80-150
- S-1140/S-1240 Clockwise closing DN 400/400-500