

# S-1140/S-1240 Resilient seat gate valve DN 80-150

DIN F4 short/DIN F5 long

02-02/1039002351/01.2007 **2**

Page 1 of 2

## Application and features

- Application: Water and sewage
- Wedge in EPDM-rubber approved for drinking water
- Design pressure 64 bar
- Clockwise closing



## Technical description

- Approvals: See separate sheet [\[Approvals\]](#)
- Standards: DIN 3352-1/4, DIN 3840, EN 545, EN 12266, ISO 7259, EN 1074, EN 1171
- Face-to-face length S-1140: EN 558/ ISO 5752 series 14
- Face-to-face length S-1240: EN 558/ ISO 5752 series 15
- Max. working pressure: PN16, vacuum -0,8 bar
- Flange drilling: Standard drillin PN 10/PN 16 (EN1092-2)
- Max. temperature: 60°C
- Test pressure open valve: 24 bar
- Test pressure closed valve: 21 bar
- Coating: Epoxy minimum 250 µm
- Product colour: Blue, RAL 5017
- Body/bonnet connection: Socket head bolts covered with wax
- Valve top: Prepared for spindle extension S-1880
- Stem: Non-rising with tapered stem end, according to DIN 87304 (see table)

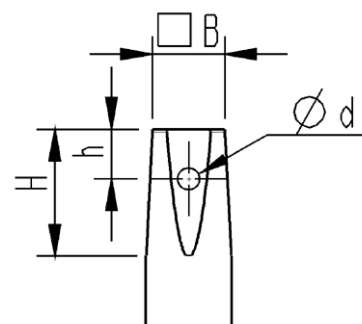

Dimensions stem top:

DN	B	H	h	d
80-150	19,3	38	17	7

## References, dimensions and performances

Series	DN mm	H mm	L mm	Weight kg	Kv m <sup>3</sup> /h	Z	Esco no.	NRF no.	Danfoss no.
S-1140	80	330	180	22	567	0,2	11400080	550 6034	149L075700
	100	324	190	23	885	0,2	11400100	550 6039	149L012300
	125	418	200	33	1384	0,2	11400125	550 6044	149L075900
	150	420	210	38	2301	0,15	11400150	550 6049	149L076000
S-1240	80	330	280	23	567	0,2	12400080	550 5407	149L078800
	100	324	300	25	885	0,2	12400100	550 5409	149L018700
	125	418	325	33	1384	0,2	12400125	550 5412	149L079000
	150	420	350	42	2301	0,15	12400150	505 5414	149L079100

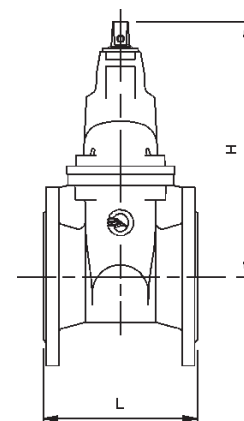

Kongsberg Esco AS can accept no responsibility for possible errors in catalogues, brochures and other printed material. Kongsberg Esco AS reserves the right to alter its products without notice. This also applies to products already on order provided that such alterations can be made without subsequent changes being necessary in specifications already agreed. All trademarks in this material are property of the respective companies. Kongsberg Esco and the Kongsberg Esco logotype are trademarks of Kongsberg Esco AS. All rights reserved.

# S-1140/S-1240 Resilient seat gate valve DN 80-150

DIN F4 short/DIN F5 long

02-02/1039002351/01.2007 **2**

Page 2 of 2

## Material specification

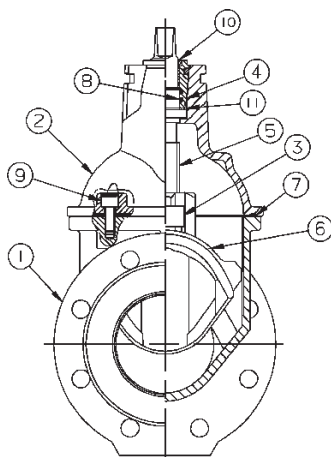

Pos	Detail	Materials
1	Body	Ductile iron EN 1563 EN-GJS-500-7
2	Bonnet	Ductile iron EN 1563 EN-GJS-500-7
3	Stem nut	Dezinkfree brass (DZR)
4	Bushing	Dezinkfree brass (DZR)
5	Stem	Stainless steel EN10088-3 1.4021
6	Wedge	Ductile iron EN1563 EN-GJS-500-7 with rubber (EPDM)
7	Gasket	Rubber approved for drinking water
8	O-rings	Rubber approved for drinking water
9	Socket head bolt	Steel 8.8
10	Dirt steal	Rubber (NBR)
11	Axial sleeve bearing	POM

## Installation

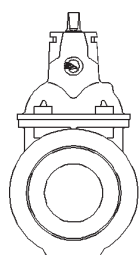

Recommended

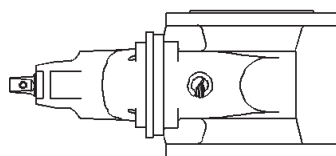

Possible

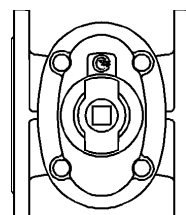

Possible

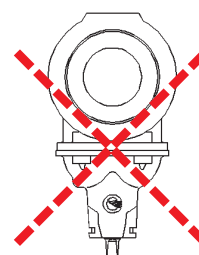

Not recommended

## Accessories and other variants

### Accessories:

- S-1120/S-1121 Norwegian cap
- S-1110 Handwheel
- S-1112 Handwheel extension L=250 (DN 100)
- S-1112 Handwheel extension L=265 (DN 150)
- S-1880 Spindle extension
- S-1880-0 Operating tool bar
- S-1830/S-1835/S-1840 Operating box

### Other variants:

- S-1140/S-1240 Clockwise closing DN 40-50
- S-1140/S-1240 Clockwise closing DN 65
- S-1140/S-1240 Clockwise closing DN 200-300
- S-1140/S-1240 Clockwise closing DN 400/400-500